

CROWN

MAKE THE
MOST OF
YOUR
CONNECTIONS

InfoLink®

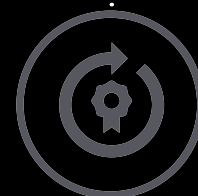
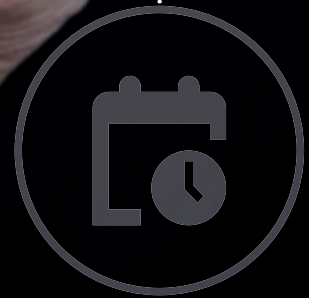

Link Equipment, People and Processes



The InfoLink® Operator and Fleet Management

System is all about
connections—linking lift
trucks, users, operations
and service. Tackle your
greatest challenges
surrounding productivity,
safety, uptime,
equipment usage and
more. In the words of a
customer, “Where we
can’t be, InfoLink is.”



Connect to Information that Matters

The InfoLink system
opens a world of data
that matters most:

- Promote and manage safety
- Uncover hidden risk
- Find cost savings
- Reinforce training
- Empower operators and managers
- Accelerate improvement

It's time to make
the most of your
connections.



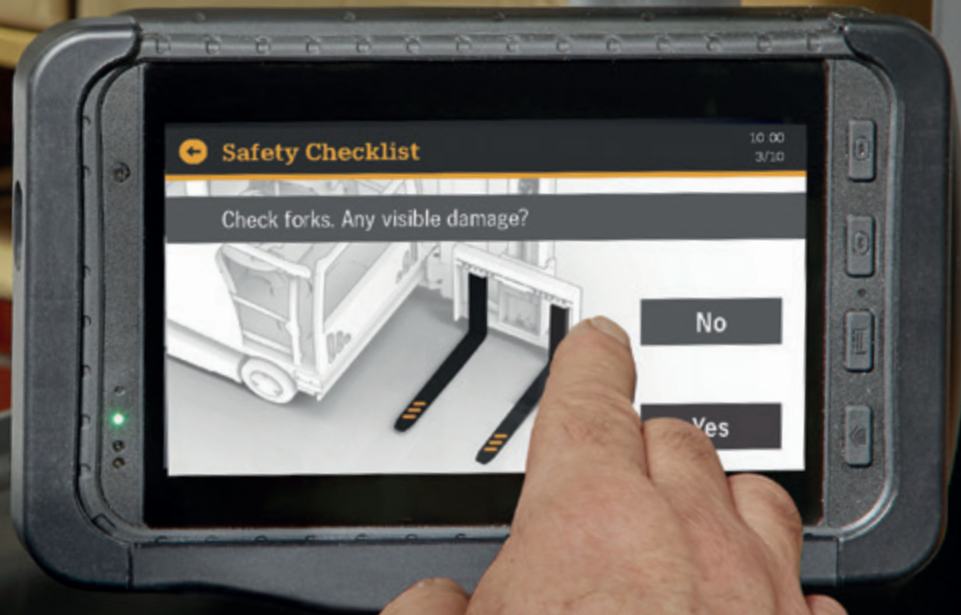

The InfoLink 7" Touch Display combines durable construction with intuitive touchscreen design for ease of use in your industrial application.

For applications that require operators to wear gloves, the InfoLink 7" Touch Display includes button navigation.



Access control, an automatic part of the login process, requires up-to-date operator certification for lift truck access.



Electronic operator daily **checklist** required for access helps ensure that the truck is safe to operate.

25+ languages improve productivity in a diverse workforce.

On-screen **safety reminders** at login help to reinforce operator training.



Impact monitoring encourages timely operator coaching and reduces damage to lift trucks, facility and products.

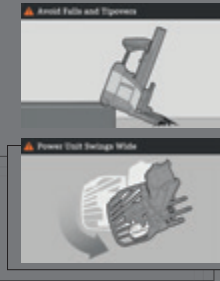

Unleash the Power of People



Dynamic Coaching™ Delivers real time visual and audible safety alerts that reinforce operator behaviours based on truck operation.



What can we do to improve operator safety?

Built on Crown's tradition of human-centred forklift design, InfoLink reinforces an experience-first approach that inspires and motivates safe operating behaviour.

Additionally, InfoLink takes you deeper with interactive data that keeps everyone informed. As one facility manager explained: "It provided data that I can't measure with a time card."

InfoLink reveals best practices and areas of risk to help with targeted improvements for new and existing operators.



The Crown Advantage

The InfoLink system and your forklift fleet are key components of your operation. Crown's expansive retail network is ready to help define and guide your InfoLink system implementation.

To maximise uptime, InfoLink field technicians, backed by dedicated factory support, provide prompt and efficient on-site installation and system optimisation.

How can we take advantage of real time operational data?



Get Inspired to Move Ahead

InfoLink provides a rich source of definitive data to help solve operational challenges.



Fleet utilisation information can help you right-size your fleet by monitoring truck availability based on lift, lower, transport and idle times.

Seasonal usage is easily recognised in customisable reports and graphs to help you plan for peak demand.



Trend analysis shows when your lift trucks are being used, helping you quantify value and make informed decisions on whether to rent or buy.

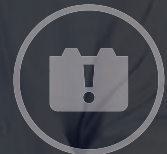

Uptime improvements can be attained with InfoLink:

- Schedules planned maintenance
- Encourages proper battery care practices
- Captures event codes when service is required
- Utilises checklist feedback to identify repairs early



Performance improvements identified through continuous monitoring and reporting provide immediate opportunities for operator feedback and training.

Make your Connection



7" Touch Display

3" Display

SAFETY	Complete electronic pre-shift inspections, manage operator certifications and monitor impacts	●	●
PRODUCTIVITY	Compare operator or team activity to department/shift benchmarks, identify long-term and seasonal trends	●	●
UPTIME	Schedule planned maintenance and communicate maintenance issues	●	●
ASSET MANAGEMENT	Manage individual lift truck assets or entire fleet across multiple locations	●	●
COST REDUCTION	Prevent expensive repairs, reduce damage from impacts and avoid regulatory penalties	●	●
TOUCH USER INTERFACE WITH WIDGETS		●	
SAFETY REMINDERS AND CHECKLIST IMAGES		●	
DYNAMIC COACHING CAPABLE		●	

InfoLink Services: Achieve More With Your Connection

Crown helps provide the additional support needed to ensure your success. From programmes designed to create a solid foundation to help you achieve your goals to data integration and other customisations to continue your journey.

- Prepare your team for the InfoLink system with the **RightStart™** programme that tailors the implementation process to meet your operational needs.
- Re-energise your organisation with InfoLink by assessing your company's current state of InfoLink usage and customising a plan to boost engagement.
- Integrate InfoLink data into your business systems through InfoLink Data Services.
- Optimise your InfoLink experience with custom reporting that provides the analytics you need in a format and frequency that fits your business.

We make it easy to leverage Crown's extensive fleet management expertise by utilising our InfoLink Services.

Contact your local Crown partner today for an on-site business review and make the most of your connections.

Visit crown.com



Crown Gabelstapler GmbH & Co. KG
Philipp-Hauck-Str. 12
85622 Feldkirchen, Germany
Tel +49(0)89-93002-0
Fax +49(0)89-93002-133
crown.com

Because Crown is continually improving its products, specifications are subject to change without notice.

Crown, the Crown logo, the color beige, the Momentum Mark, InfoLink, Dynamic Coaching, RightStart, JumpStart, FleetSTATS and the ecologic logo are trademarks of Crown Equipment Corporation in the United States and other countries

Copyright 2019 Crown Equipment Corporation
InfoLink BROCH GB 01/20, 10 – M01707-006-00
Printed in Germany



Printed on elemental chlorine free and sustainably forested paper.

 twitter.com/crown_europe_en

 news.crown.com/uk/feed/